

PI STATION = 1452+88.94
 DELTA = 0° 32' 29.78" (RT)
 DEGREE OF CURVE = 0° 15' 00.00"
 TANGENT = 108.32
 LENGTH = 216.64
 RADIUS = 22,918.31
 PC STATION = 1451+80.61
 PT STATION = 1453+97.26

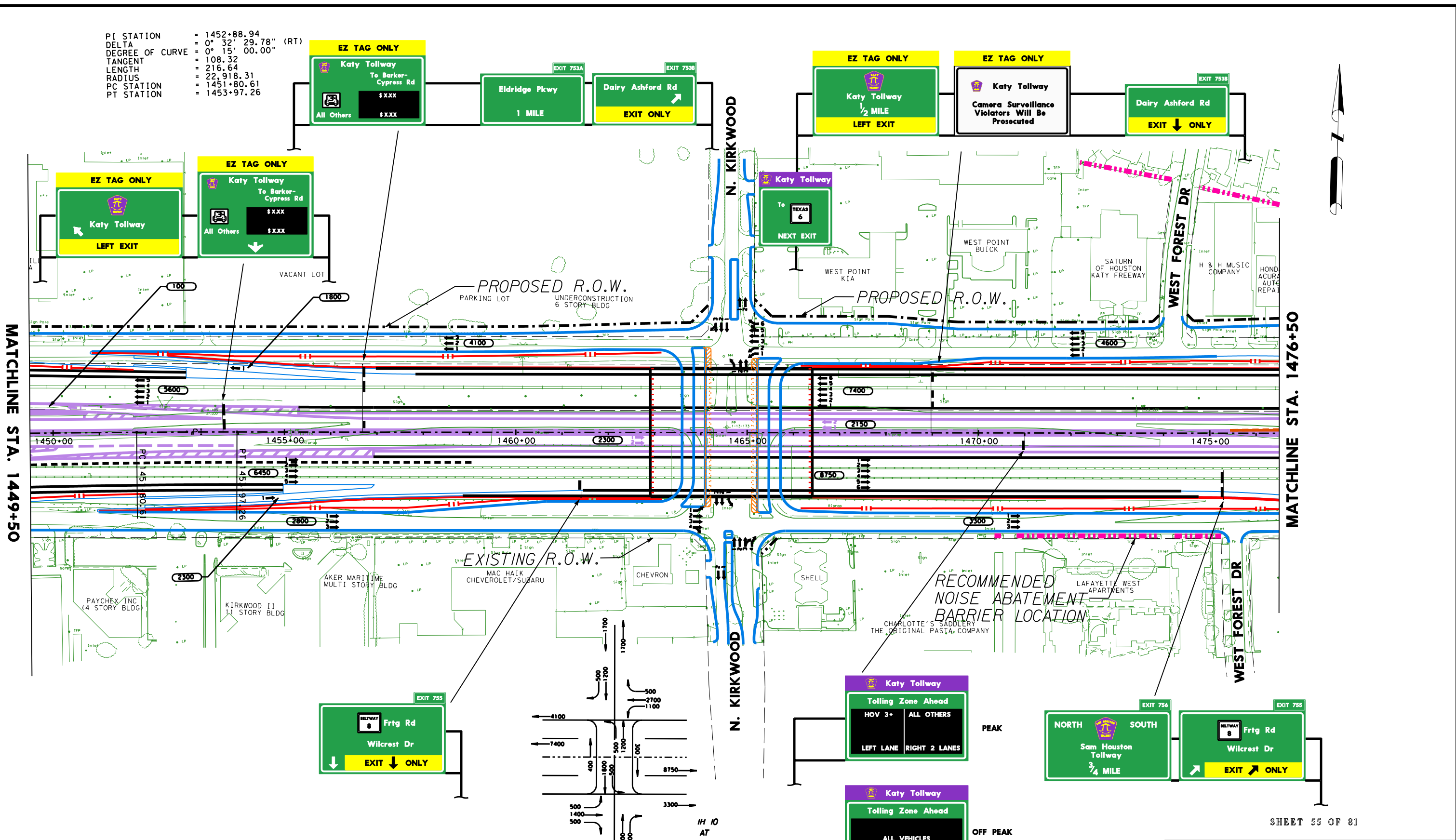

SHEET 55 OF 81

SCHEMATIC LAYOUT
 HARRIS COUNTY
 IH 10 KATY FRWY
 FROM: BRAZOS RIVER
 TO: TAYLOR ST
 HOUSTON DISTRICT

DATE: AUG. 2000
 APPROVED: JUNE 19, 2003